

LIGHT CONCRETE INSULATION SOLUTION

Super Isomur LC

It is a “wall tie-anchor system” for all types of rigid and semi-rigid insulation on all kinds of base materials: **cellular concrete**

The combination of this insulation plug with a wall tie has been created for connecting the two leaves of a cavity wall with insulation fixed to the internal leaf. The wall ties are driven in the plugs which results in a very low thermal conductivity.

Designed for light concrete the SUPER ISOMUR LC anchor has got an extra long expansion zone with many rings on the outside of the shank to optimize the anchorage in the cellular concrete.

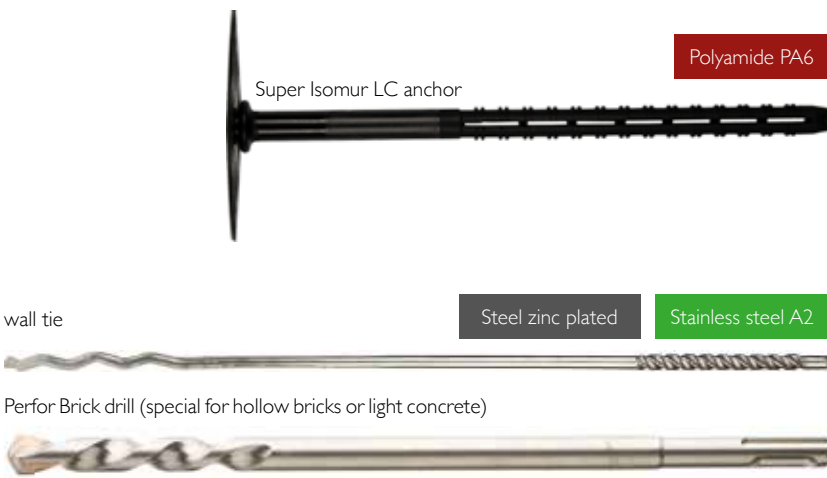

Specifications

- **Diameter of the plate:** 60 mm
- **Diameter of the anchor:** 8 mm
- **Colour:** black
- **Quality:** polyamide PA 6.6 - Ultramid B35
- **Quality of the wall tie:** stainless steel A2 or steel zinc plated
- **Length of the expansion zone:** 100 mm
- **Length of the twisted shank of the wall tie:** 50 mm
- **Length of the drive-in pipe:** 140 mm (to shorten on site)
- **Pull out tests wall tie out of the anchor:** >100 daN
- **Pressure resistance / density of the cellular concrete = min. C3/450**

SUPER ISOMUR LC anchor + PERFOR BRICK drill in light concrete = QUICK, SAFE, STRONG and PERMANENT!

A “wall tie- anchor system” for fixing, among others, rigid insulation panels on cellular aerated concrete.

- No special tools required: 1 hammer + 1 metal drive-in pipe (included)
- Plug with extra long expansion zone of 100 mm.
- 4 lengths available: 160 mm - 180 mm - 200 mm and 250 mm.
- High grade ultramid polyamide PA 6.6 quality plug together with a stainless steel A2 or A4 wall tie, secures a permanent and stable interconnection of masonry.
- The insulation panels will be held strongly by the plug only (wind resistant).
- Beware: protruding ties can be a danger to site workers. Wall ties should only be hammered into the plugs at the moment of bricklaying the outerleaf.
- Drill the hole deep enough with a drill of Ø 8 mm in the light concrete.
- Recommended on light concrete: PERFOR BRICK drill is available in Ø 8 mm and 2 lengths: 200/260 mm and 410/460 mm.



Due to a policy of continual development, Etanco BNL reserves the right to change product specifications and descriptions without prior notice. Etanco BNL can not guarantee the completeness of the information as there are too many factors that can influence the appropriate use and application of this fixing system. In this respect, Etanco BNL can not accept any responsibility based on the given information.

Installation of the SUPER ISOMUR LC

A complete installation instruction sheet is available on www.etanco.be.

1. Drill a hole: \varnothing 8 mm in the light concrete
2. Hammer the black insulation plug in the hole.
3. Simply push the wall tie in the center hole of the plate.
4. Slide the drive-in pipe over the tie end.
5. Hammer the pipe to the plate of the anchor.
6. Slightly bend the wall tie downwards.

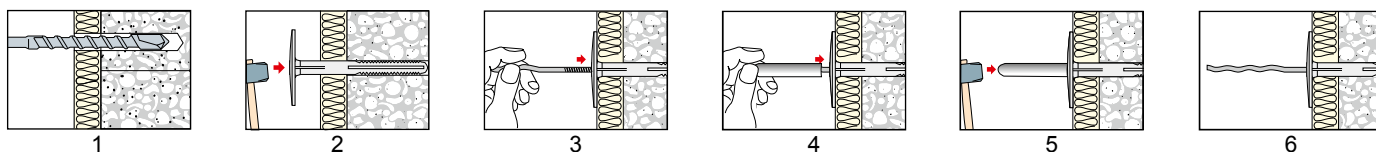

BEWARE: protruding ties can be a danger to site workers. Wall ties should only be hammered into the plugs at the moment of bricklaying the outer leaf.



Type	lg. anchor (mm) ***	lg. wall tie (mm)	thickness of isolation (mm)	cavity (mm)	drive-in pipe **	sales unit *	Code Steel plated	Code Stainless steel A2
SICL 8 x 60/160	160	240	60	30	140	250	2358716	2358616
SICL 8 x 80/180	180	260	80	30	140	250	2358718	2358618
SICL 8 x 100/200	200	280	100	30	140	250	2358720	2358620
SICL 8 x 140/240	240	320	max. 140	30	140	250	2358724	2358624

* Packaging: 1 box: 250 anchors + 250 wall ties (bundled) + 1 drive-in pipe

** To shorten on site: length wall tie minus length of anchor

*** Wall ties will be longer or shorter depending on the cavity. Other combination: anchor plug / wall tie available on request.

- ▶ \varnothing of the shank of the insulation plug is \varnothing 8 mm
- ▶ the wavy part of the wall tie will get stuck in the mortar of the outer leaf
- ▶ drilling depth = length of the plug minus insulation thickness + 20 mm
- ▶ **application:**
 - predrill with a stone drill bit of \varnothing 8 mm, hammer function switched off!
 - use our Perfor Brick drill bit, also suitable for hollow clay bricks, lengths of 260 mm and 460 mm.



drive-in pipe

Dealer